

PC card drilling dimensions(after plating)  
(thickness 1.60±0.20mm)

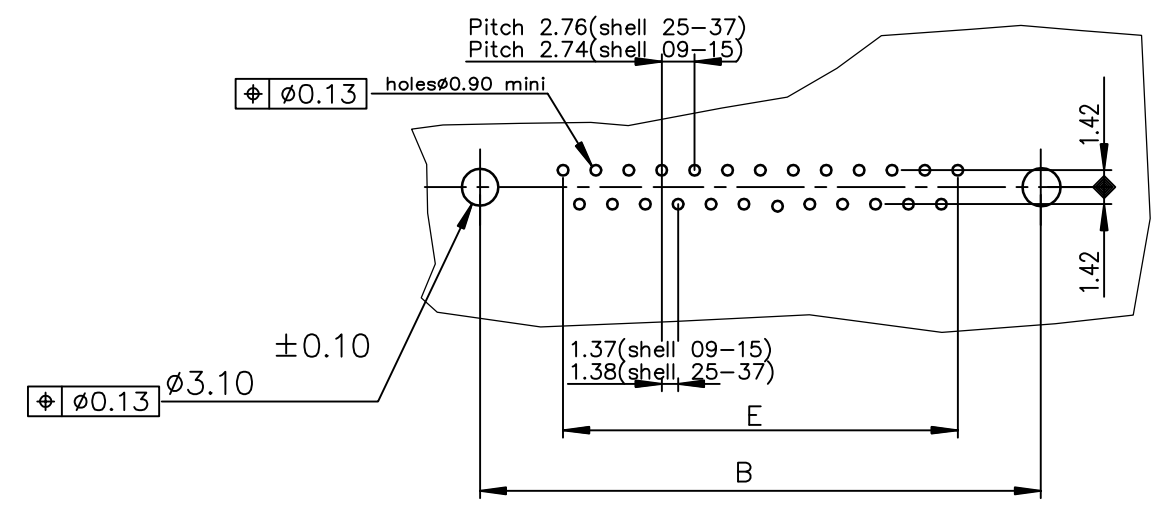

Notes:  
1) The nut can protrude above the surface of insulator but maintaining the footprint dimension 6.0±0.15 mm.

GENERAL CHARACTERISTICS AND ROHS INFORMATIONS:  
SEE DRAWING C01-8646-0000

LEAD FREE PART NUMBER

SHELL	A±0.38	B±0.12	C±0.10	D±0.25	E±0.07	PART NUMBER
09	30.81	24.99	16.96	16.21	10.96	D09S24A.PX00LF
15	39.14	33.32	25.18	24.54	19.18	D15S24A.PX00LF
25	53.03	47.04	39.12	38.25	33.12	D25S24A.PX00LF
37	69.32	63.50	55.68	54.71	49.68	D37S24A.PX00LF

Plating: 4 --> Flash Au  
Plating: 6 --> 0.76µ Au

mat'l. code		surface ISO 1302 ✓		tolerance ISO 406 ISO 1101		projection		product family D-SUB	
ltr		ecn no		dr		date		title	
E		ELX-I-22878		AB		2015/01/06		FEMALE CONNECTOR STD EUROPE STRAIGHT SOLDER TYPE FOR PCB 1.6mm	
angles		linear		.0±0.1		MM		FEM	
0±2'				.00±0.1		scale 2:1		sheet 1 of 1	
dr		engr		chr		app		size A3	
JOURBERT		ALIAS BABU		MITHUN PAUL		BIJU K PAUL		C01-8646-0492	
1996/09/10		2015/01/06		2015/01/06		2015/01/06		Product Customer Drawing	
sheet index		revision sheet		E		1			